



CLEARWATER
BRIGHT AND BEAUTIFUL - BAY TO BEACH

Prepared by:
Department of Public Works - Engineering
Geographic Technology Division
100 S. Myrtle Ave, Clearwater, FL 33756
Ph: (727)562-4750, Fax: (727)526-4755
www.MyClearwater.com

Disclaimer:

Public information data is furnished by the City of Clearwater Public Works Department, and must be accepted and used by the recipient with the understanding that the data received was collected for the purpose of developing a graphic infrastructure inventory. As such, the City of Clearwater makes no warranties, expressed or implied, concerning the accuracy, completeness, reliability, or suitability of this data for any other particular use. Furthermore, the City of Clearwater assumes no liability whatsoever associated with the use or misuse of such data.

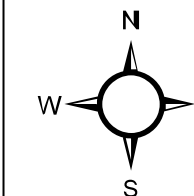

Legend

- *1234 Address
- 123 MHP Lot Number
- 10001 Subdivision/Condo Number (* - Refer to Plat)
- (A) Block ID
- (1) Sub-Parcel Number
- (11/01) Parcel Number (M&B)
- Land Hook (Common Ownership)
- Platted Subdivision Boundary
- Lot Ownership Line
- Original Platted Lot Line

Other Features

- Unincorporated
- Building Footprint
- Parcel Boundaries
- Structures
- Bicycle Trail
- Other Trail

Property with Agreement to Annex

- Sanitary Sewer ATA
- Other Services ATA
- ATA Outside Chain of Title

City Owned Properties (##)

- Vacant
- Parks/Beach
- Improved
- Stormwater
- Leasehold
- CRA Downtown
- CRA Greenwood

HOUSE ATLAS

Updated: 1/10/2025

SE 1/4 of 16-29-15

295B

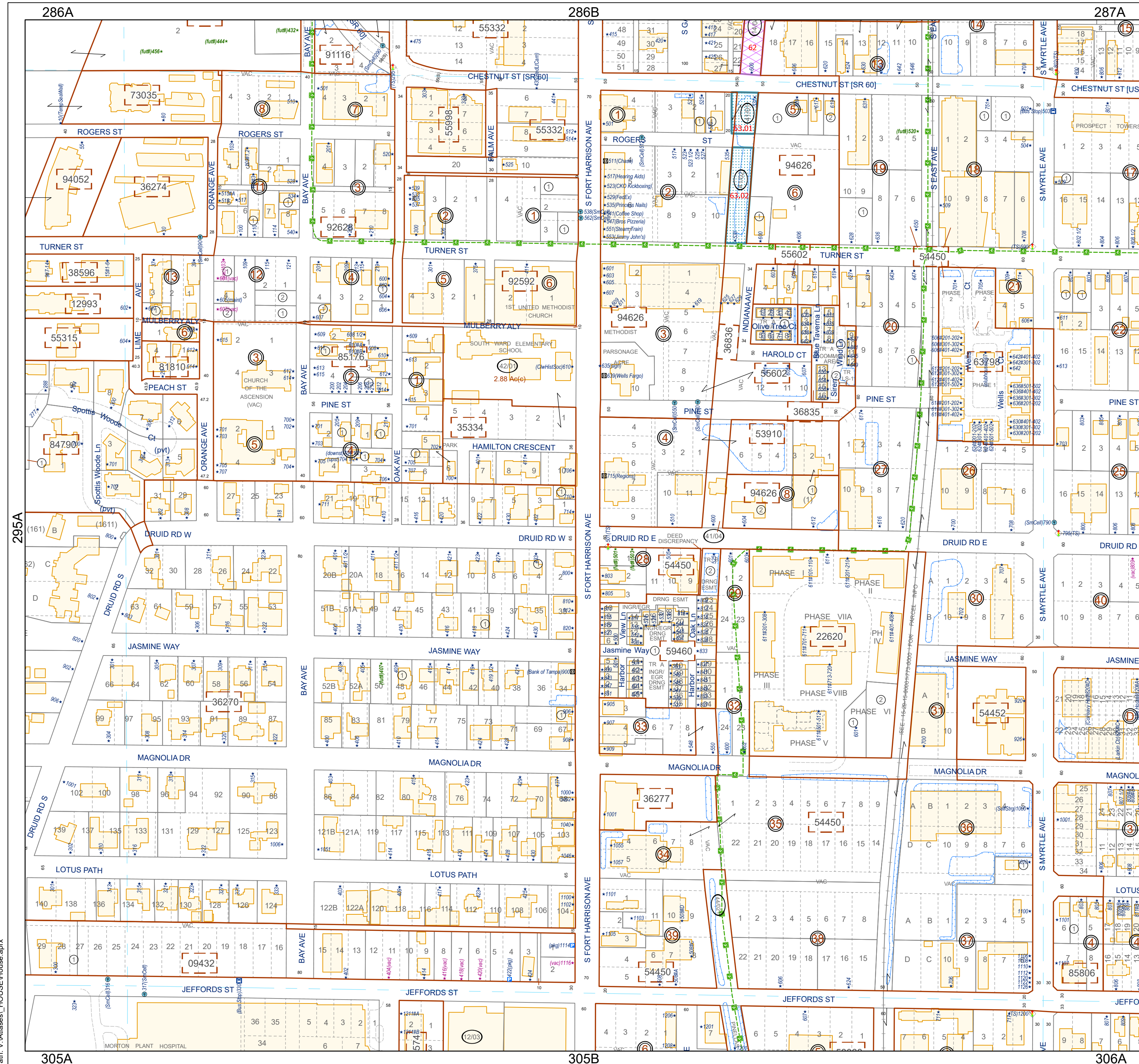

Path: V:\Atlases_HOUSE\House.aprx